

MODERN INDUSTRIES, INC.

613 WEST 11TH STREET, ERIE, PENNSYLVANIA 16501

PH: (814) 455-8061 FAX: (814) 453-4382

www.modernind.com

Order Online at

www.modernind.com/worksupports

Or fax to (814) 453-4382 ATTN: Work Support

COD & Credit Cards Accepted

Work Stop – Small = \$81.90 to *

Work Stop – Large = \$87.80 to *

** Includes head and handle on Tall unit. Optional custom features available at extra cost. Also available without tip or handle. Plus shipping and handling , FOB Erie, PA. USA*

Quantity Discounts Available



Contract Manufacturing

Heat Treating

Materials Research Division

Products Division



PRODUCTS THAT WORK

WORK
SUPPORTS

*Built for
Production...
By Toolmakers...*

www.modernind.com/worksupports





WHY TRUST MODERN'S WORK SUPPORTS... Simple... Because we use them!

Modern's Toolmakers support over 100 CNC machines. After struggling with over priced, poor performing work supports, they designed their own. We believe that Modern's work support is superior to all other manual work stops on the market and would like to share them with you!

Problem

(competitors product)

- Cost too high.
- Product does not perform.
- Work Support fell apart during normal use.
- Limited Configurations.
- Unable to Support the 4th Point.

Solution

(Modern's Work Support)

- Modern's price up to 40% below competitor.
- Rugged and built to last in tough production conditions.
- Construction tested in a vise, competitors were crushed beyond use. While Modern's work stop was not affected.
- Modern's Work Supports features 2 sizes with several head options.
- Designed a small work support to fit application.

Custom size, bolt pattern and head configuration available upon request.

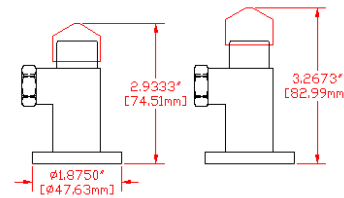

.334" [8.48mm]
Travel



WORK SUPPORTS THAT WORK!

- Will not compress after clamping
- New Internal Design
- Will not disassemble during operation.
- Flange Mounting for #10 SHCS
- 1 ½ inch Bolt Circle hole pattern
- Swivel and V Notch Head Configuration
- Maximum Load Capacity 4100# (tall model), 2800# (short model)
- Modular
- Fixed Spring Pressure 6.5# Max.
- Tool Steel Construction

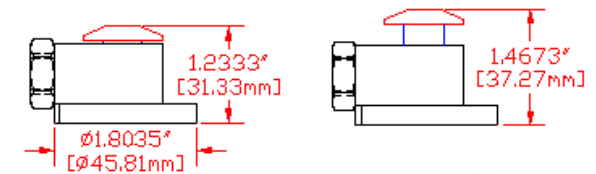

.234" [5.94mm]
Travel



Specifications subject to change without notice.